

Courses & Distances  
Down the Creek

- N 74 W 10
- N 42 W 12
- N 11 W 18
- N 21 E 16
- N 74 E 8
- S 76 E 18
- S 87 E 15
- N 73 E 19
- N 33 E 27
- N 16 E 20
- N 3 E 54
- N 27 W 34
- N 58 W 34
- S 52 W 21
- S 19 W 13
- S 68 W 33
- N 40 W 21
- N 1 E 38
- N 47 W 12
- N 77 W 40
- S 39 W 19

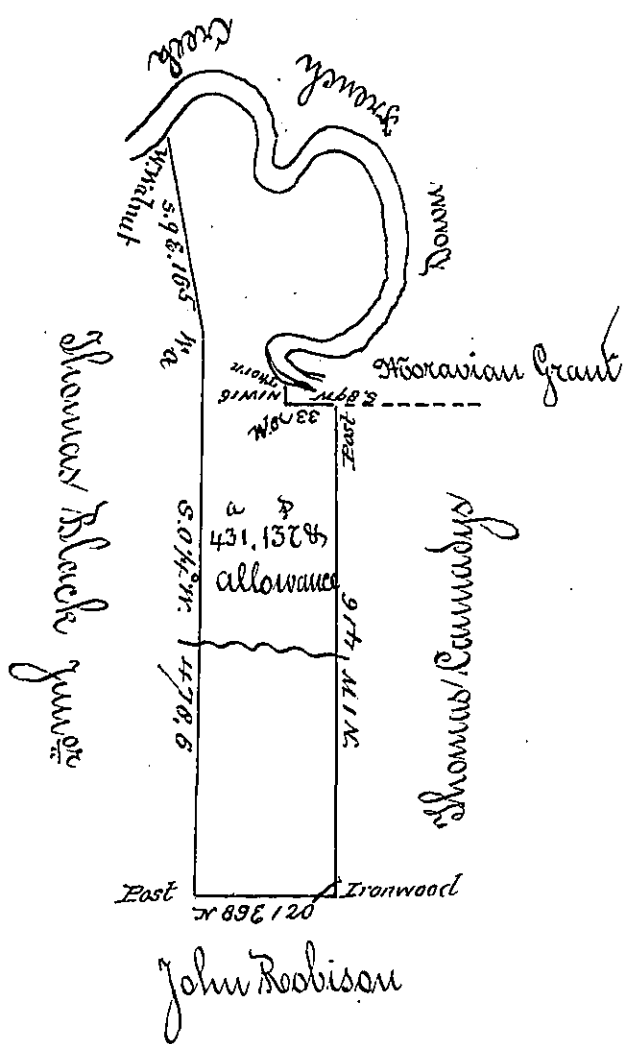

A Draught of a tract of Land situate on the East side of French Creek in Le Beuff Township Erie County surveyed the 10<sup>th</sup> day of April 1816 for William Black on an order of Resurvey bearing Date the 5<sup>th</sup> day of February 1816 Containing Four Hundred & Thirty one acres & one Hundred & Thirty seven perches & allowance of six per Cent & Co

To Richd. S. Keach Esq.  
Surveyor General

Jonah Cowgill D. S.

IN TESTIMONY that the above is a copy of the original remaining on file in the Department of Internal Affairs of Pennsylvania, made conformably to an Act of Assembly approved the 16th day of February, 1833, I have hereunto set my Hand and caused the Seal of said Department to be affixed at Harrisburg, this fifth day of August 1902.

*James W. Latta*  
Secretary of Internal Affairs.